

PIVOT DOOR Specs



Description

Armored entrance door for large wall openings 1,2m-1,9m wide, 2m-4m high. It rotates to an axis, and offer equivalent safety as our hinged entrances. It consists of a reinforced galvanized steel core, with rockwool insulation, and a variety of panels for both sides (aluminum, glass, wood). The frame is powder-coated galvanized steel and is covered with molding in the same colour of the panels. This structure ensures that the door will not warp when exposed to extreme temperatures.

Note: The order is placed using the frame dimensions **A & a**

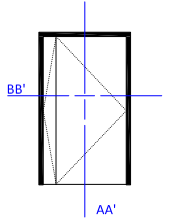

O = Axis distance from the frame
 from 1200 up to 1500, O=210
 from 1501 up to 1700, O=310
 from 1701 up to 1900, O=410

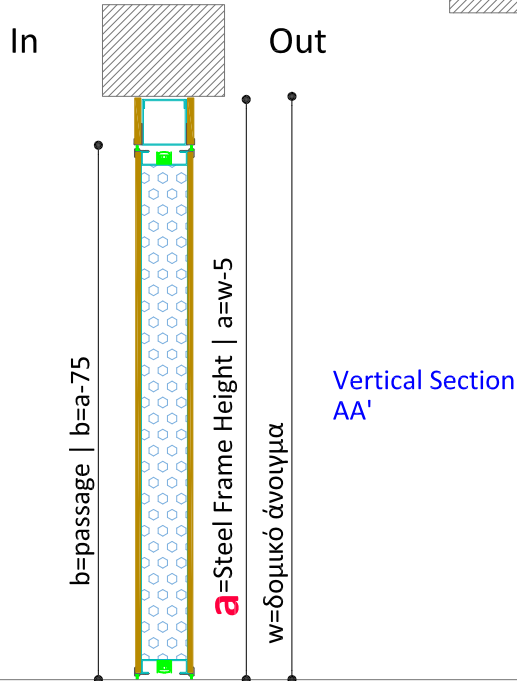
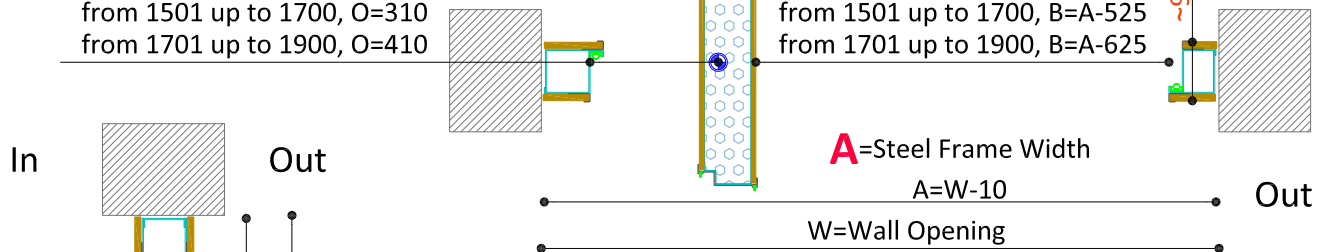

Typology

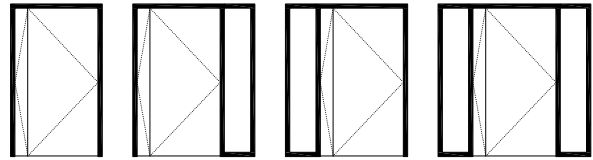

Fixings can be a) coplanar with the doorleaf b) Sidelights with a triplex-glass panel (low-iron is optional)

Standard Equipment

- Galvanized steel metal frame
- Reinforced galvanized steel core with rockwool insulation
- Adjustable heavy-duty axis hinge
- 8-point european cylinder gear lock
- Drop-down seal on top and bottom of the door
- EPDM gasket on side frames and double brushes on the doorleaf

Exterior-use colours

- Aluminum:** RAL, EFFECTS
- GLASS:** RAL
- WOOD:** Solid, Oak Plywood (HYDRO-OIL) (wood requires regular maintainance)

Interior-use colours

- Laquered:** RAL (Matt, Gloss, Textured)
- Wood:** Oak veneer (SD OAK), American walnut veneer

Extras

- Electromechanic lock with options of keyboard or fingerprint to open the door
- Engraved handle options
- Concealed door-closer with possibility to hold the door open
- Aluminum saddle (silver)

